

21300 W 8 Mile Rd.
Southfield, MI 48075-5638

ENTRY-FIT™ "K2A-Series" ADJUSTABLE STEEL DOOR FRAME Utilizing a Steel Door Panel "IMPACT"

GENERAL NOTES

1. This product has been evaluated and is in compliance with the 5th Edition (2014) Florida Building Code (FBC) structural requirements including the "High Velocity Hurricane Zone" (HVHZ).
2. Product anchors shall be as listed and spaced as shown on details. Anchor embedment to base material shall be beyond wall dressing or stucco.
3. When used in the "HVHZ" this product complies with Section 1626 of the Florida Building Code and does not require an impact resistant covering.
4. When used in areas outside of the "HVHZ" requiring wind borne debris protection this product complies with Section 1609.1.2 of the FBC and does not require an impact resistant covering. This product meets missile level "D" and includes Wind Zone 4 as defined in ASTM E 1996 and Section 1609.1.2.2 of the FBC.
5. This product has been tested with the door panels as specified in this approval. Substitution of a similar product may be approved for use by the local Authority Having Jurisdiction. In all cases, the steel door used must possess a comparable current Florida Statewide product approval. The door panel size and design pressure (DP) rating shall not exceed the sizes and DP ratings shown in this approval or the steel side hinged swing door approval being used.
6. Site conditions that deviate from the details of this drawing require further engineering analysis by a licensed engineer or registered architect.
7. Configurations utilizing the high-dam outswing bump threshold (item #30) meet water infiltration requirements for the "HVHZ".
8. Configurations utilizing inswing threshold (item #31), outswing threshold (item #32) and the ADA threshold (item #33), do not meet the water infiltration requirements for the "HVHZ". These units shall be installed only in non-habitable areas or at habitable locations protected by an overhang or canopy such that the angle between the edge of canopy or overhang to sill is less than 45 degrees.
9. When used in the "HVHZ", steel must be protected as specified in FBC Section 2222.6.

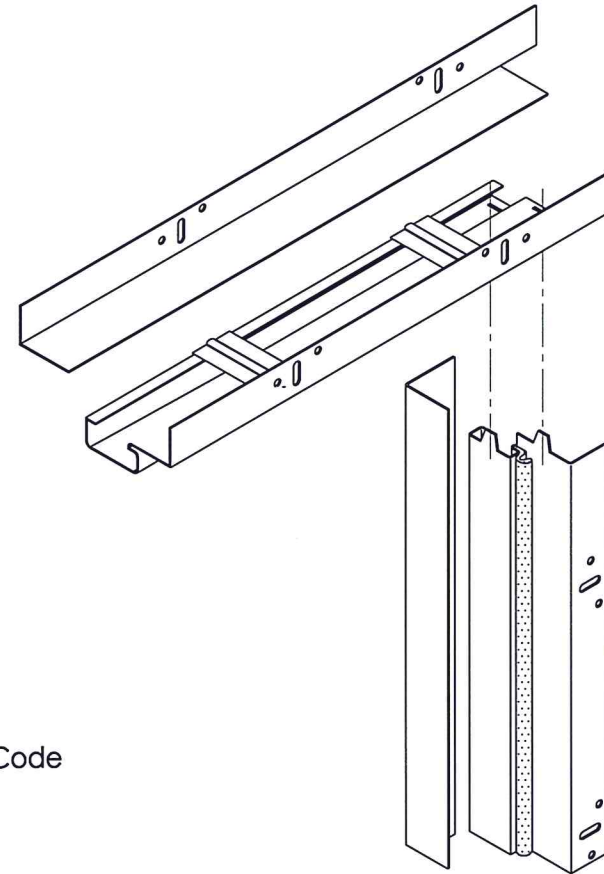

ADJUSTABLE STEEL DOOR FRAME
K2A-Series

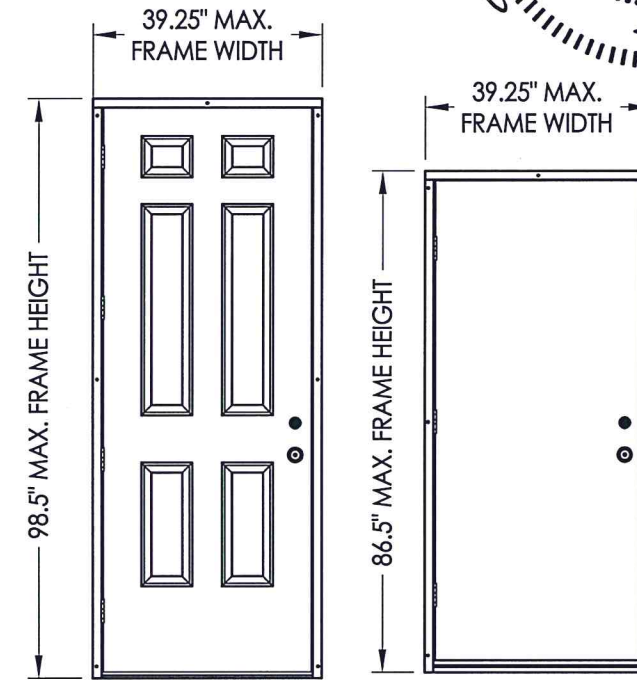

INSWING OR OUTSWING

DOOR PANEL	MAX. OVERALL FRAME DIMENSION	DESIGN PRESSURE (PSF) INSWING		DESIGN PRESSURE (PSF) OUTSWING	
		POSITIVE	NEGATIVE	POSITIVE	NEGATIVE
JELD-WEN	39.25" X 86.5"	+ 75.0	- 75.0	+ 65.0	- 75.0
JELD-WEN	39.25" X 98.5"	+ 60.0	- 70.0	+ 60.0	- 60.0

TABLE OF CONTENTS	
SHEET#	DESCRIPTION
1	Typical elevations, design pressures & general notes
2	Door panel details
3	Door panel details
4	Corner detail
5	Elevations
6	Horizontal cross sections
7	Vertical cross sections
8	Frame & buck anchoring (7'-0" door)
9	Frame & buck anchoring (8'-0" door)
10	Bill of materials and components

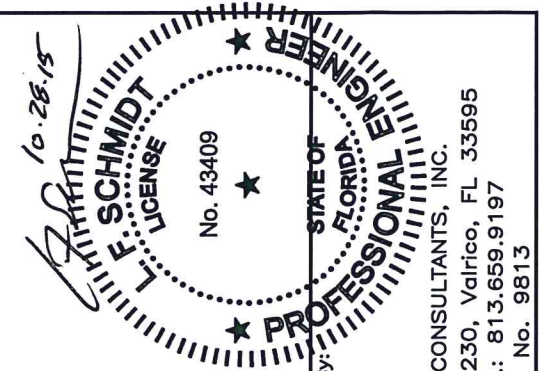

Documents Prepared By:
Lyndon F. Schmidt
P.E. No. 43409

RW BUILDING CONSULTANTS, INC.
P.O. Box 230, Valrico, FL 33595
Phone No.: 813.659.9197
FBPE C.A. No. 9813

PRODUCT: IDP STEEL FRAME (K2A-SERIES)
PART OR ASSEMBLY: TYPICAL ELEVATION, DESIGN PRESSURE & GENERAL NOTES

NO.	DATE	BY

DATE: 10/23/15
SCALE: N.T.S.
DWG. BY: JK
CHK. BY: LFS
DRAWING NO.: FL-14512.4
SHEET 1 OF 10

R:\Clients\IDP PERMANENT\A - Florida Product Approvals\FL-14512\C - Drawings\Current\FL-14512.4.dwg, FL-14512.4

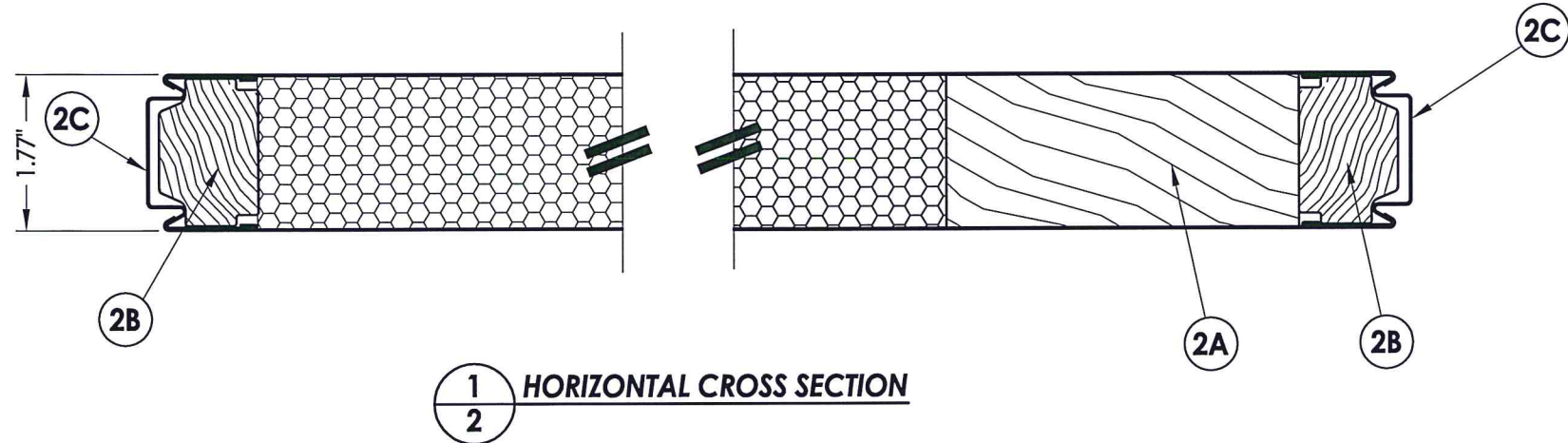

1
2 **HORIZONTAL CROSS SECTION**

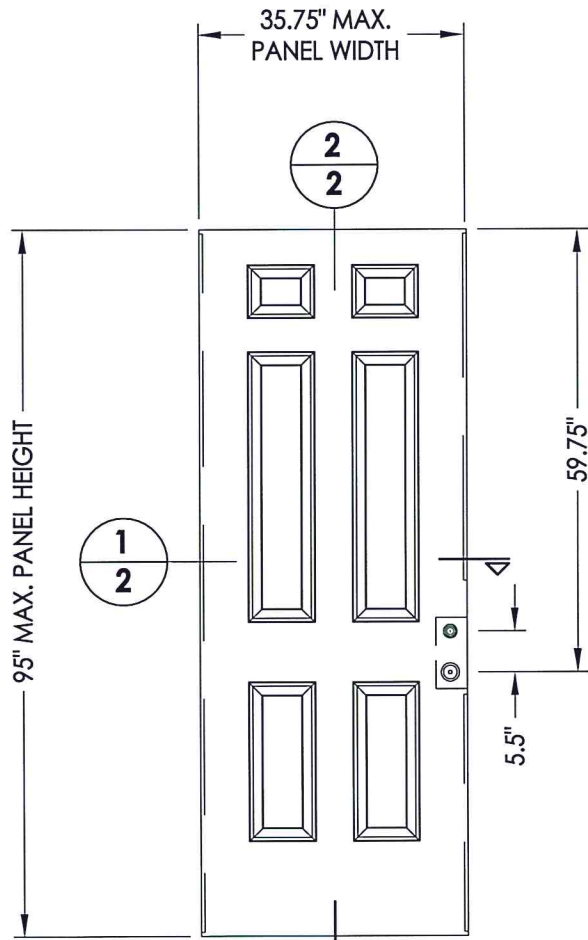

40 **8' - DOOR PANEL**
Steel (JELD-WEN)

STEEL DOOR SKIN: MIN. 0.022\"/>

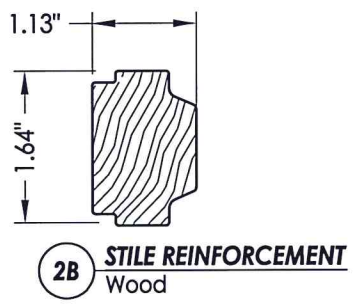

2B **STILE REINFORCEMENT**
Wood

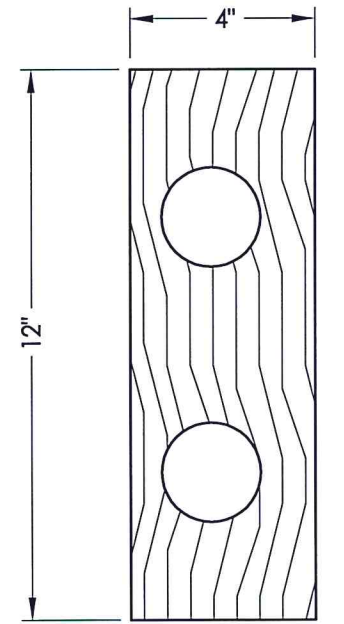

2A **LOCK BLOCK**
Wood

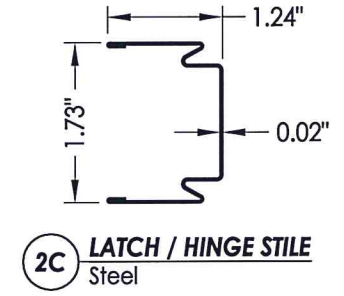

2C **LATCH / HINGE STILE**
Steel

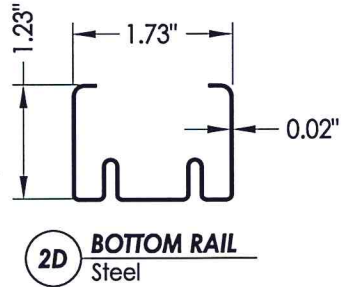

2D **BOTTOM RAIL**
Steel

STEEL DOOR SKIN
0.022\"/>

POLYSTYRENE FOAM CORE

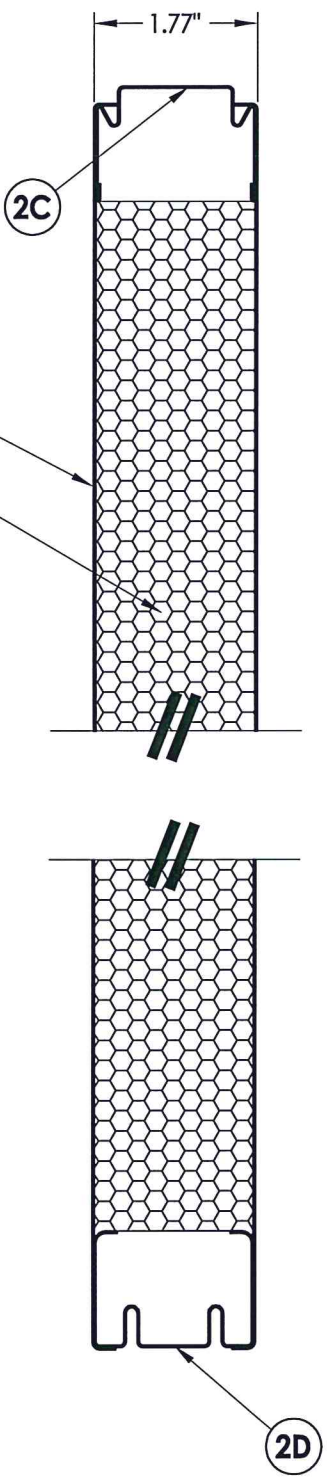

2
2 **VERTICAL CROSS SECTION**

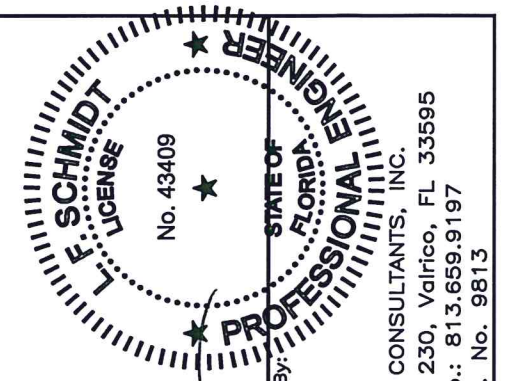

LFS
10.28.15

Documents Prepared By:
Lyndon F. Schmidt
P.E. No. 43409

R.W. BUILDING CONSULTANTS, INC.
P.O. Box 230, Vairico, FL 33595
Phone No.: 813.659.9197
FBPE C.A. No. 9813

PRODUCT:	IDP STEEL FRAME (K2A-SERIES)
PART OR ASSEMBLY:	DOOR PANEL DETAILS

NO.	DATE	BY

DATE:	10/23/15
SCALE:	N.T.S.
DWG. BY:	JK
CHK. BY:	LFS
DRAWING NO.:	FL-14512.4
SHEET	2 OF 10

R:\Clients\IDP PERMANENTVA - Florida Product Approvals\FL-14512\C - Drawings\Current\FL-14512.4.dwg, 3.1

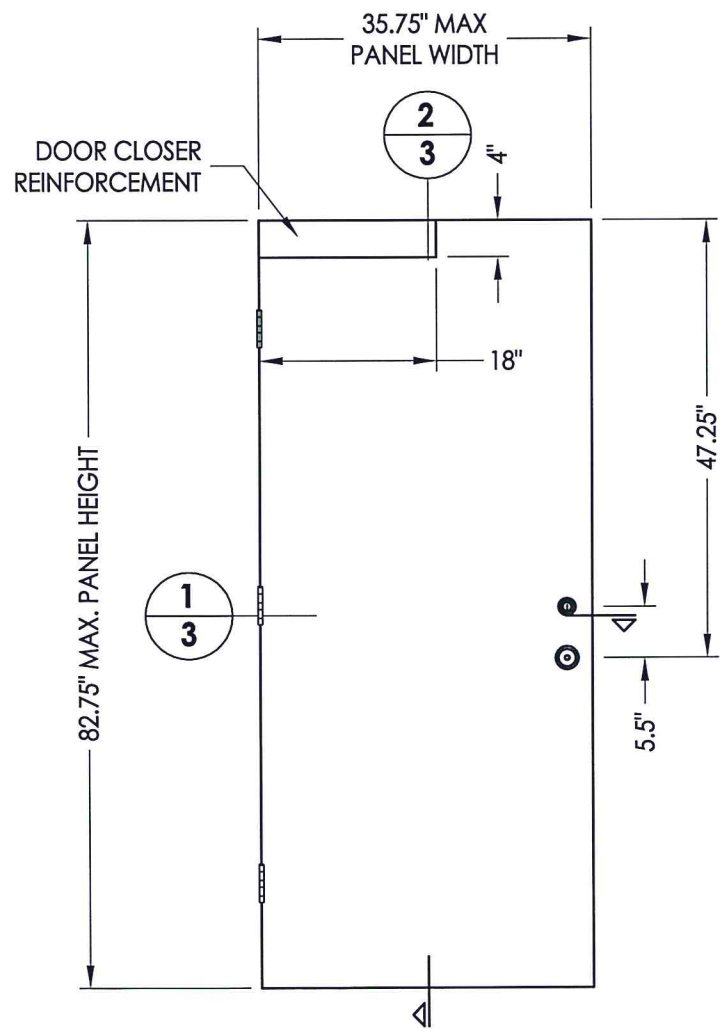

50 7' - DOOR PANEL
Steel (JELD-WEN)

STEEL DOOR SKIN: MIN. 0.022" THK.
GALVANIZED STEEL (Fy = 48,000 PSI MIN.)

1 3 HORIZONTAL CROSS SECTION

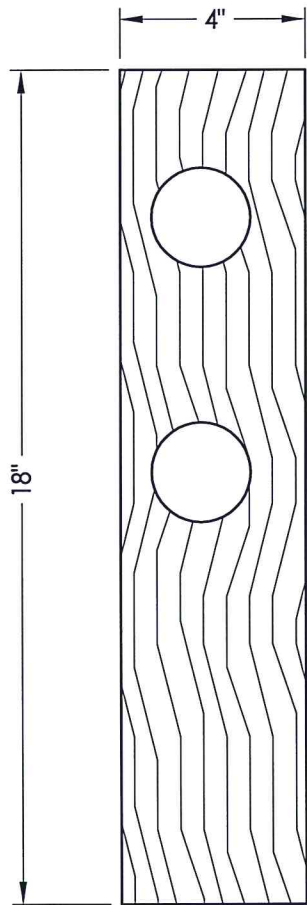
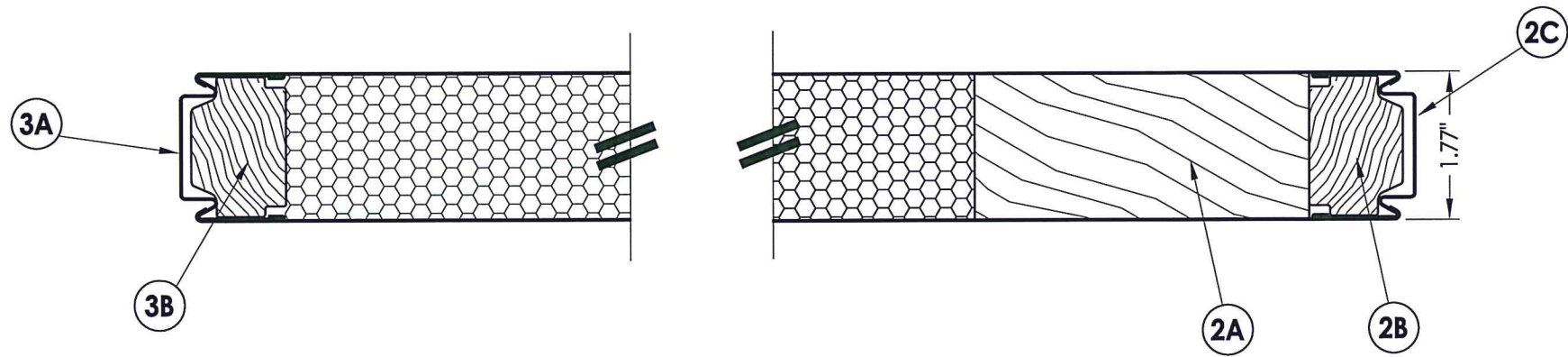

3A LOCK BLOCK
Wood

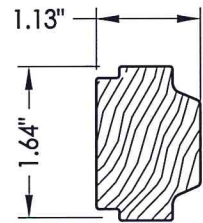

3B STILE REINFORCEMENT
Wood

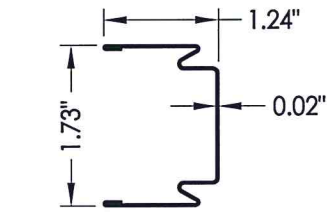

3C LATCH / HINGE STILE
Steel

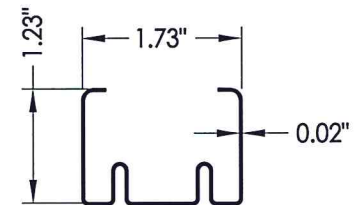

3D BOTTOM RAIL
Steel

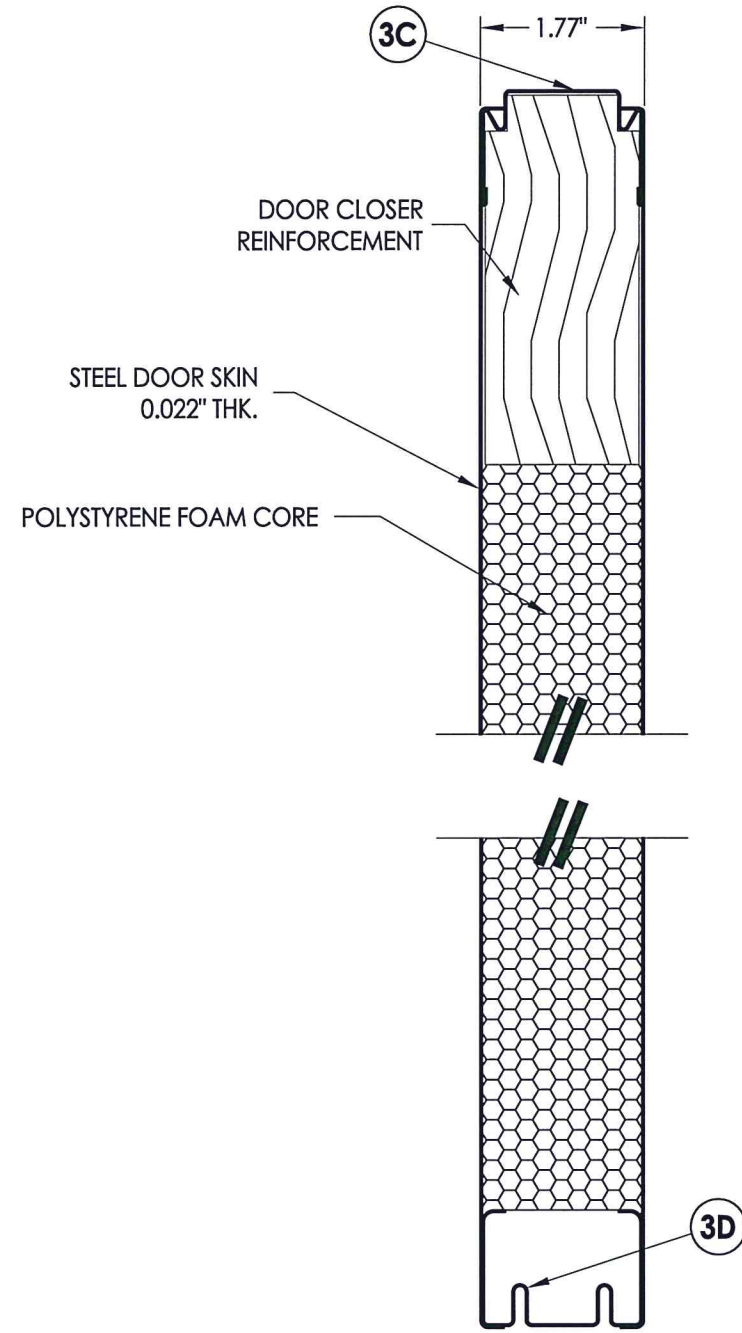

2 3 VERTICAL CROSS SECTION

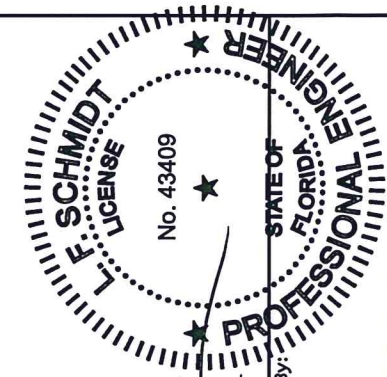

LFS
10.23.15

Documents Prepared By:
Lyndon F. Schmidt
P.E. No. 43409

RW BUILDING CONSULTANTS, INC.
P.O. Box 230, Valrico, FL 33595
Phone No.: 813.659.9197
FBPE C.A. No. 9813

PRODUCT:	IDP STEEL FRAME (K2A-SERIES)
PART OR ASSEMBLY:	DOOR PANEL DETAILS

NO.	DATE	BY

DATE:	10/23/15
SCALE:	N.T.S.
DWG. BY:	JK
CHK. BY:	LFS
DRAWING NO.:	FL-14512.4
SHEET	3 OF 10

© 2015 R.W. BUILDING CONSULTANTS INC.

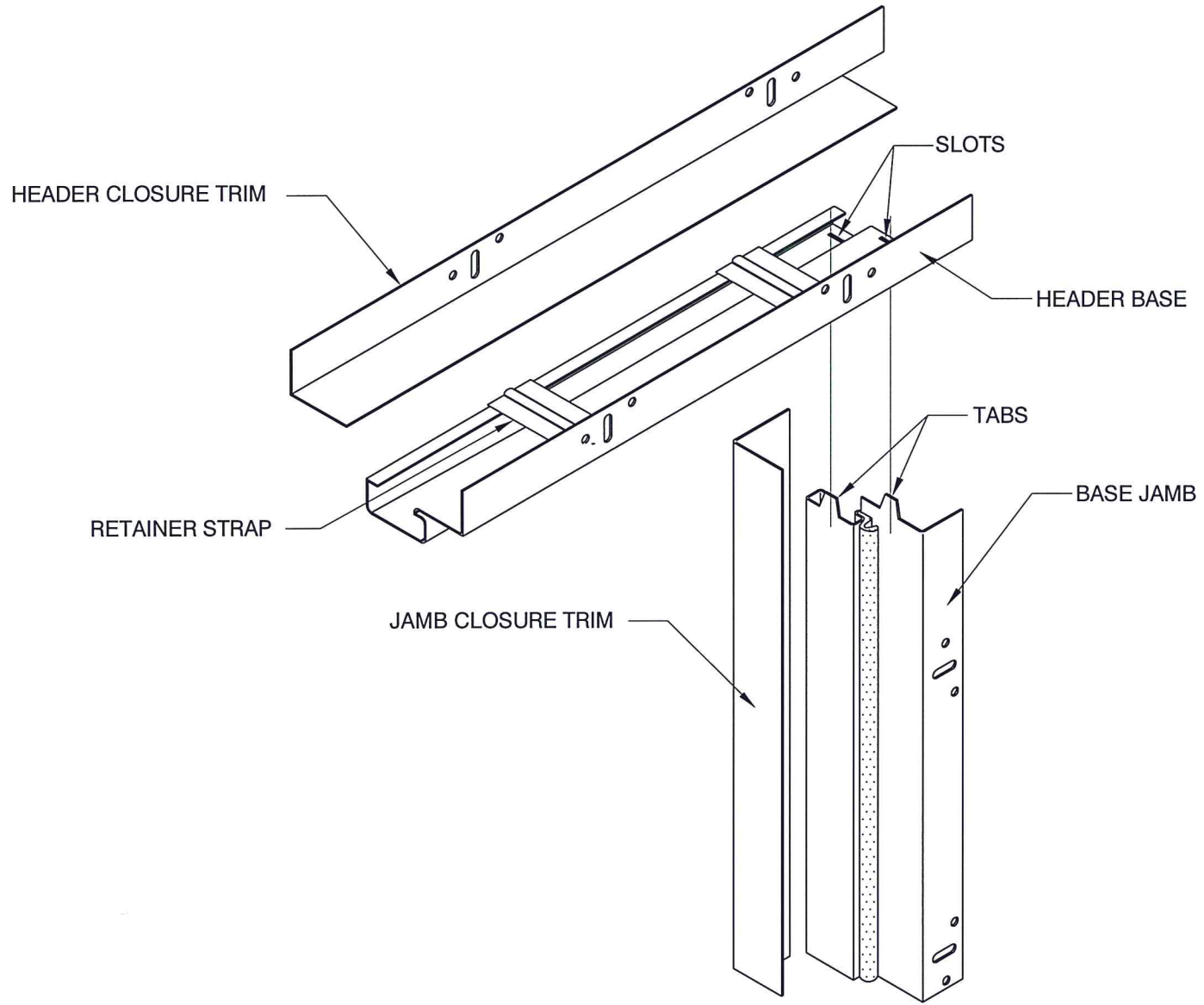
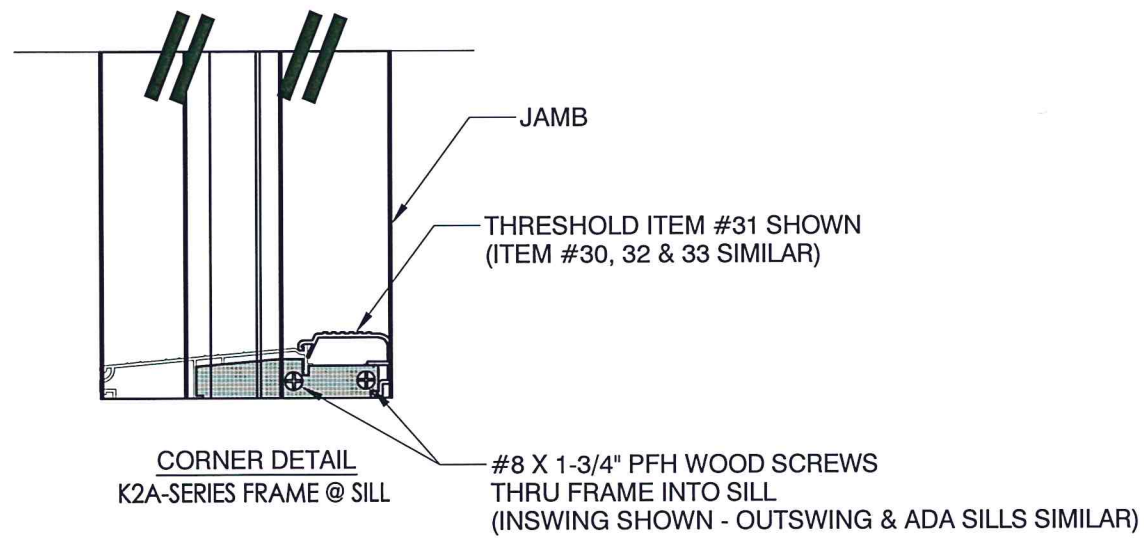

CORNER DETAIL
IDP ENTRY-FIT™ ADJUSTABLE
STEEL DOOR FRAME (K2A-SERIES)

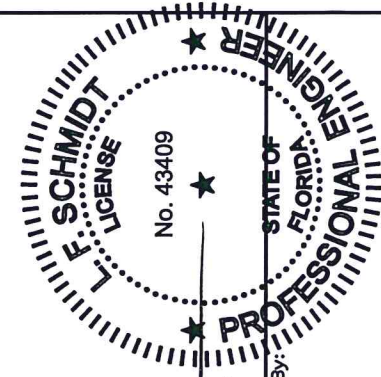

Documents Prepared By:
Lyndon F. Schmidt
P.E. No. 43409

RW BUILDING CONSULTANTS, INC.
P.O. Box 230, Valrico, FL 33595
Phone No.: 813.659.9197
FBPE C.A. No. 9813

PRODUCT:	IDP STEEL FRAME (K2A-SERIES)
PART OR ASSEMBLY:	CORNER DETAIL

NO.	DATE	BY

DATE: 10/23/15
SCALE: N.T.S.
DWG. BY: JK
CHK. BY: LFS
DRAWING NO.: FL-14512.4
SHEET 4 OF 10

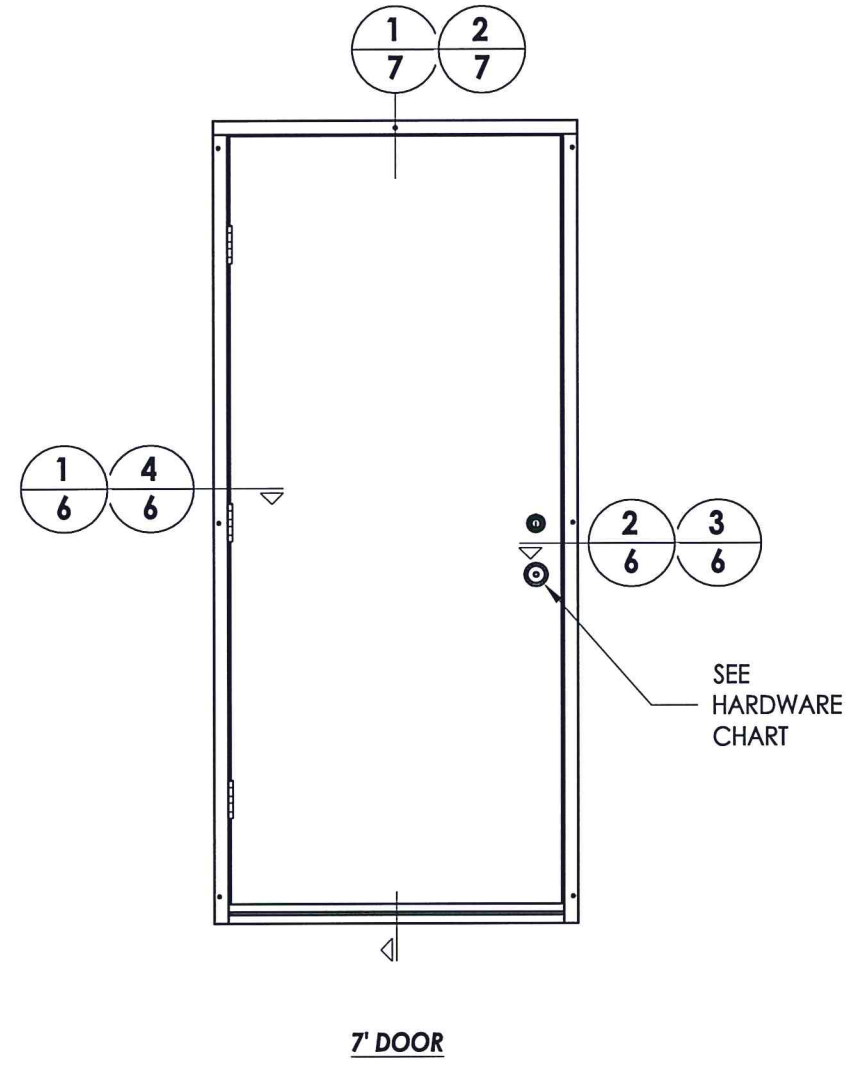
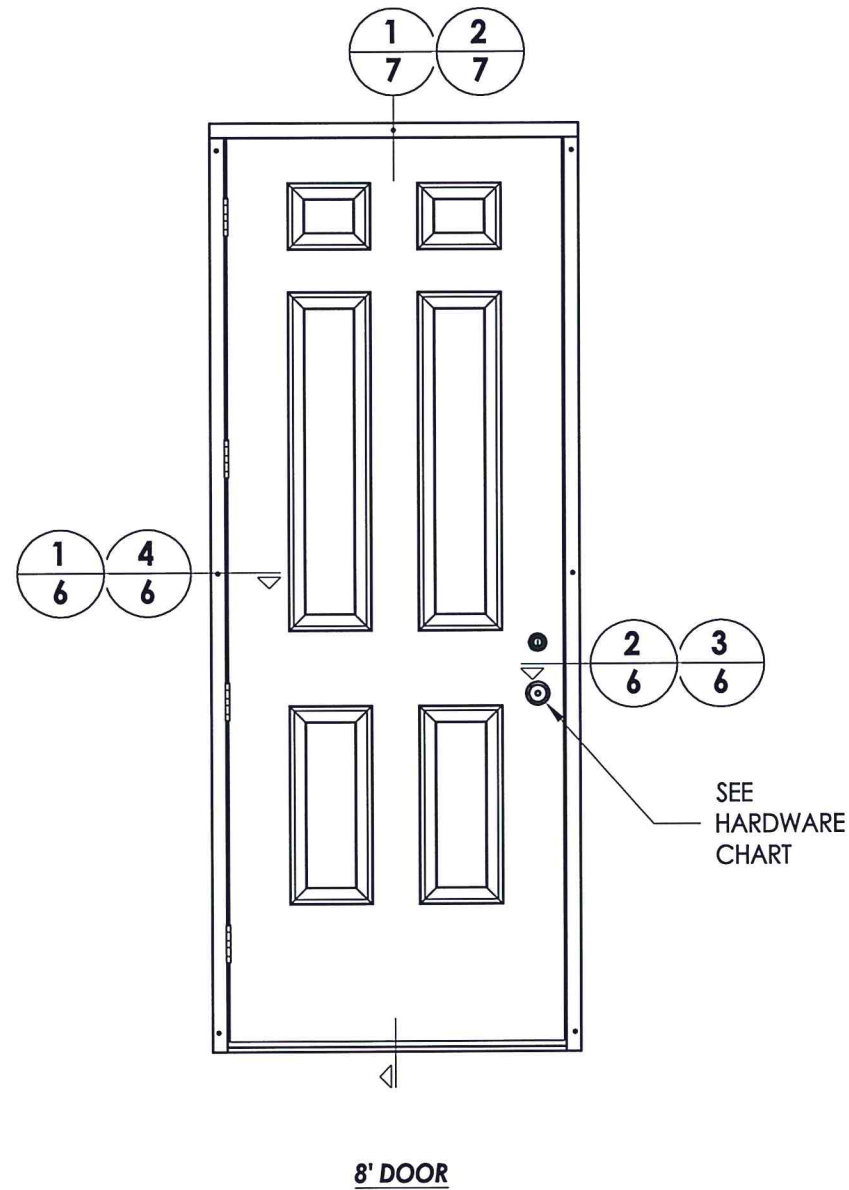

HARDWARE CHART	
MANUFACTURER	MODEL
KWIKSET	LOCK: SIGNATURE SERIES DEADBOLT: SIGNATURE SERIES (980)
SCHLAGE	LEVER: "F" SERIES (F51) DEADBOLT: "B" SERIES (B300)

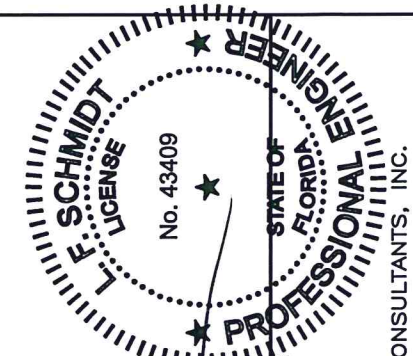

LFS
10.28-15

Documents Prepared By:
 Lyndon F. Schmidt
 P.E. No. 43409

R.W.
 BUILDING CONSULTANTS, INC.
 P.O. Box 230, Vairico, FL 33595
 Phone No.: 813.659.9197
 FBPE C.A. No. 9813

PRODUCT: IDP STEEL FRAME (K2A-SERIES)	PART OR ASSEMBLY: ELEVATIONS	
REVISIONS		
NO.	DATE	BY
DATE: 10/23/15 SCALE: N.T.S. DWG. BY: JK CHK. BY: LFS DRAWING NO.: FL-14512.4 SHEET <u>5</u> OF <u>10</u>		

R:\Clients\IDP PERMANENT\A - Florida Product Approvals\FL-14512\C - Drawings\Current\FL-14512.4.dwg, 6.1

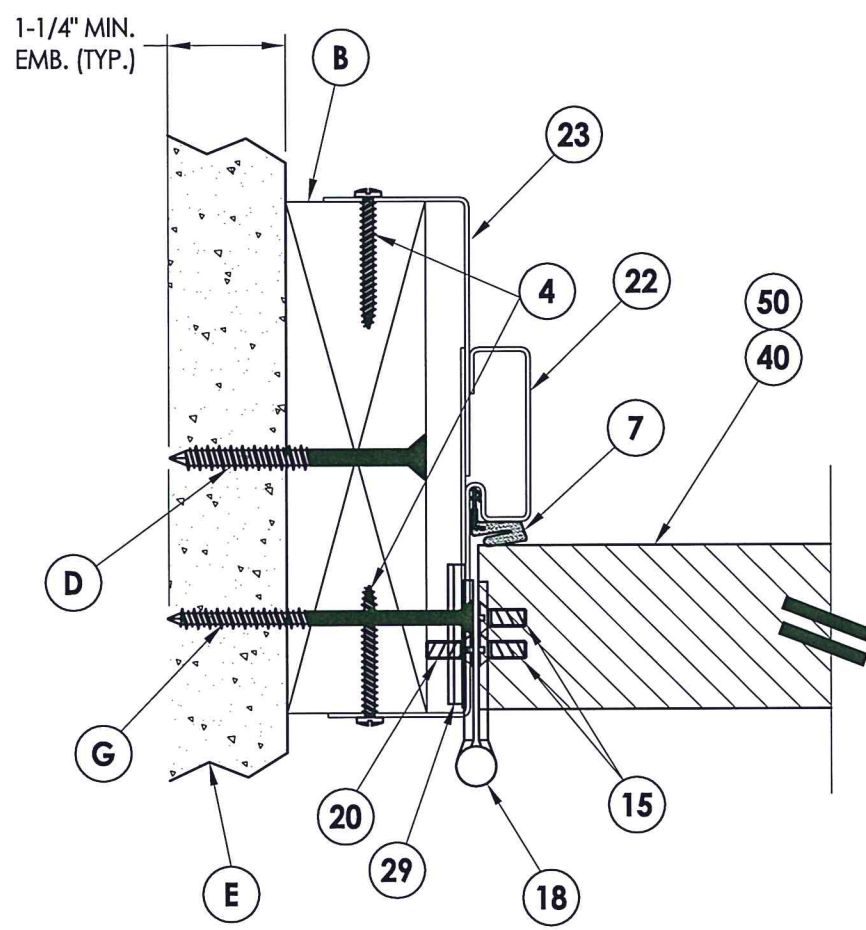

1 HORIZONTAL CROSS SECTION
6 2x Buck Construction

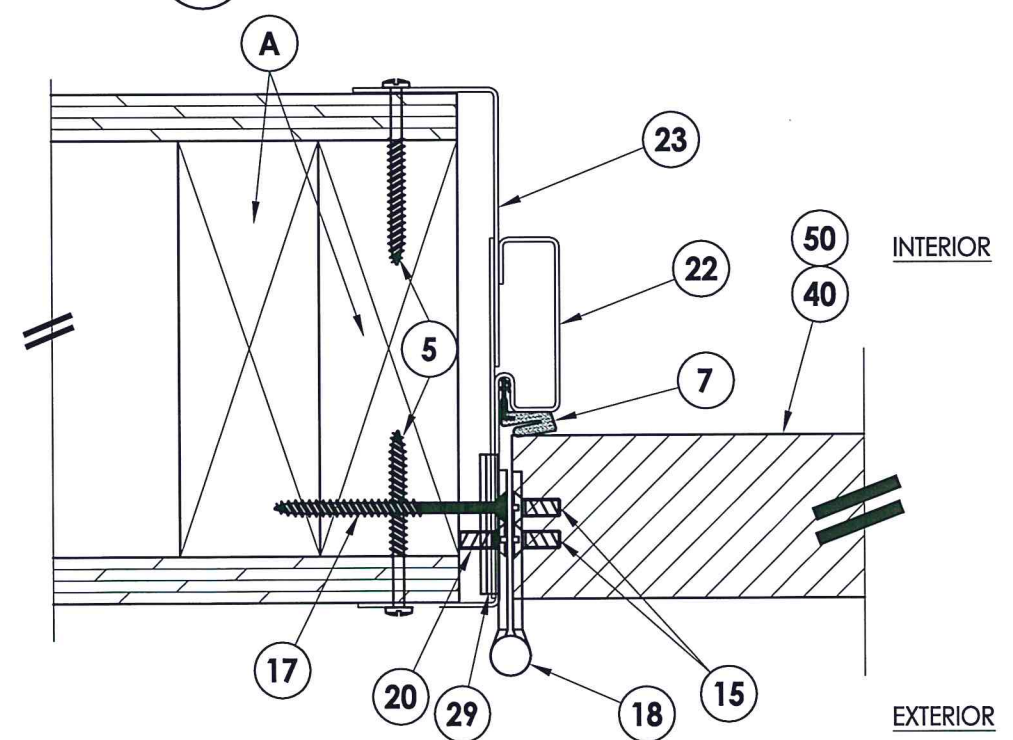

4 HORIZONTAL CROSS SECTION
6 2x Stud Construction

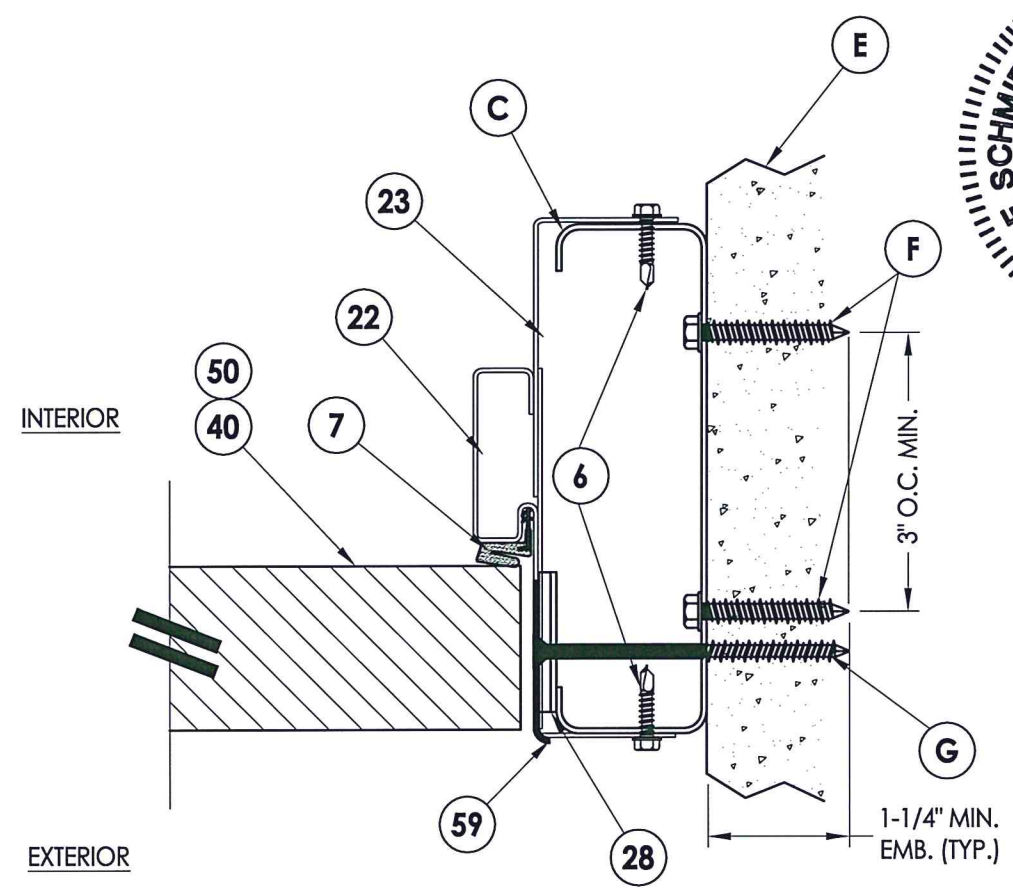

2 HORIZONTAL CROSS SECTION
6 Metal Stud Construction

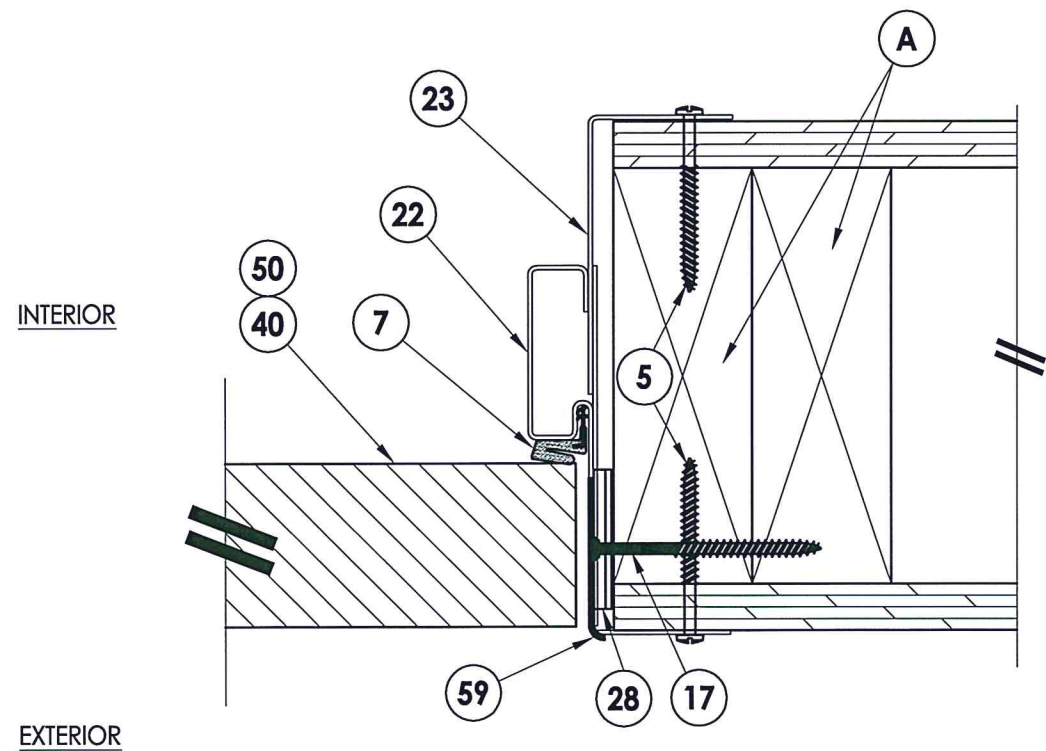

3 HORIZONTAL CROSS SECTION
6 2x Stud Construction

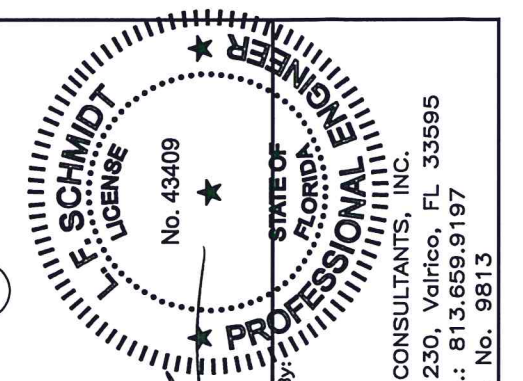

Documents Prepared By:
Lyndon F. Schmidt
P.E. No. 43409

R.W. BUILDING CONSULTANTS, INC.
P.O. Box 230, Valrico, FL 33595
Phone No.: 813.659.9197
FBPE C.A. No. 9813

PRODUCT:	IDP STEEL FRAME (K2A-SERIES)
PART OR ASSEMBLY:	HORIZONTAL CROSS SECTIONS

NO.	DATE	BY	REVISIONS

DATE:	10/23/15
SCALE:	N.T.S.
DWG. BY:	JK
CHK. BY:	LFS
DRAWING NO.:	FL-14512.4
SHEET	6 OF 10

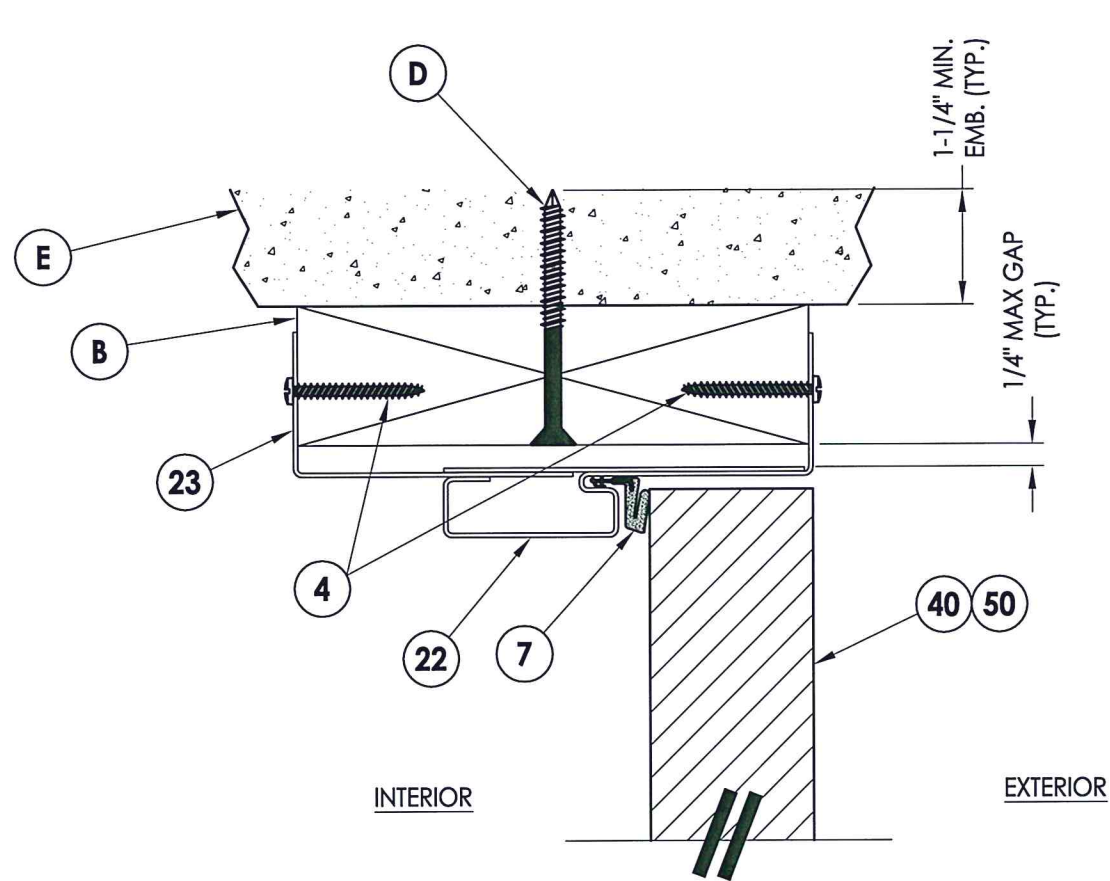

1 VERTICAL CROSS SECTION
7 Outswing

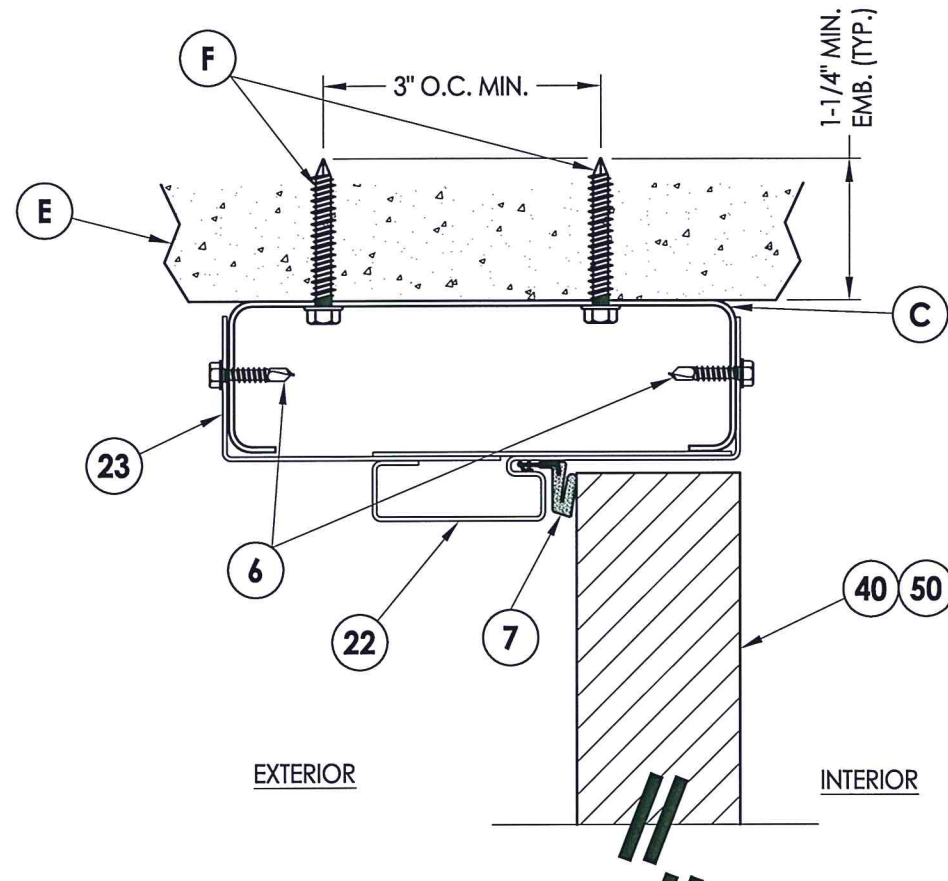

2 VERTICAL CROSS SECTION
7 Inswing

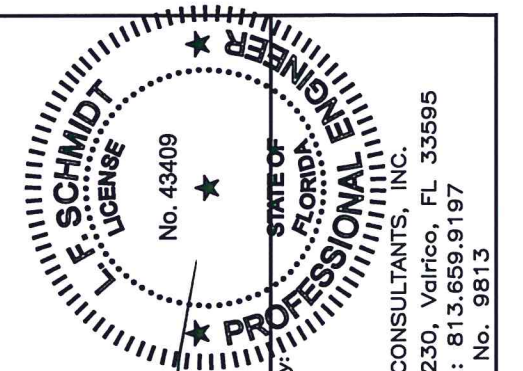
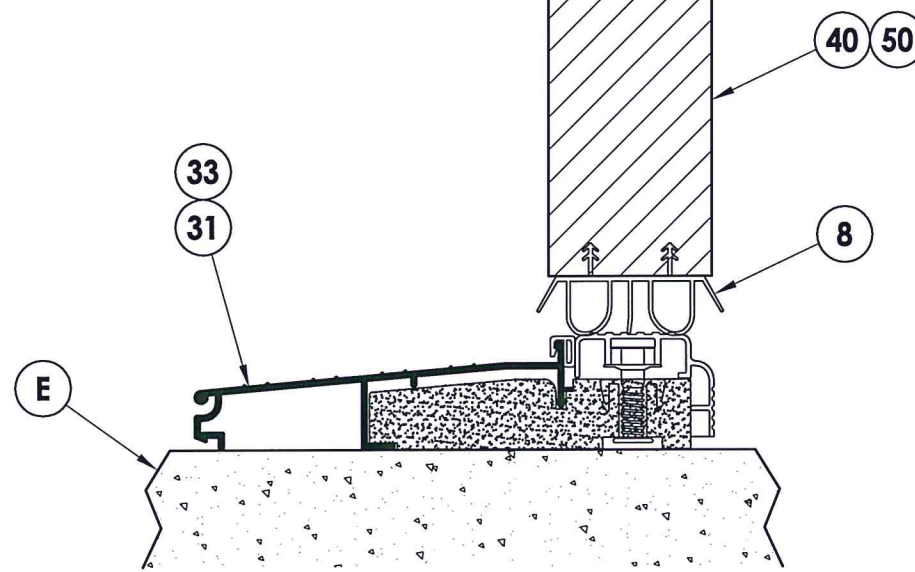
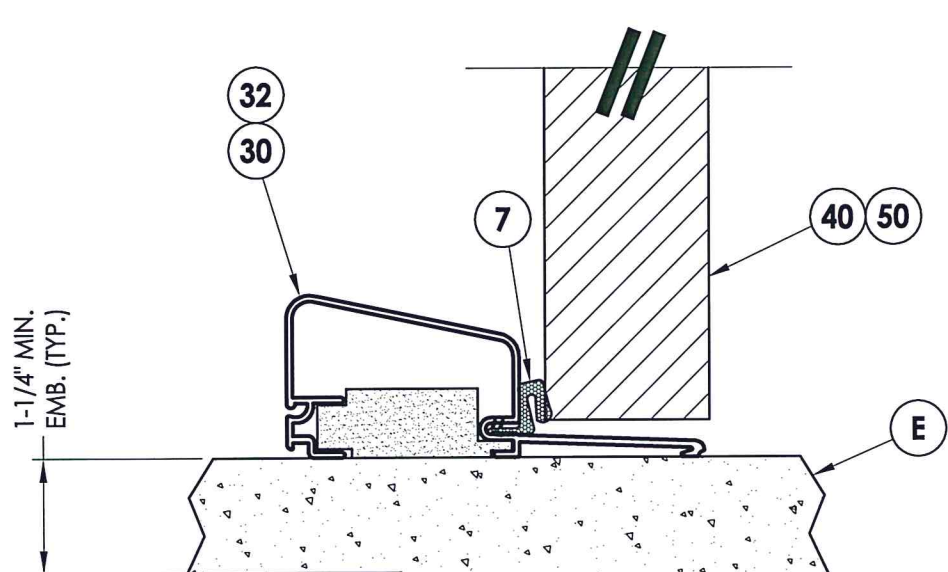

Documents Prepared By:
Lyndon F. Schmidt
P.E. No. 43409
RW BUILDING CONSULTANTS, INC.
P.O. Box 230, Valrico, FL 33595
Phone No.: 813.659.9197
FBPE C.A. No. 9813

PRODUCT:	IDP STEEL FRAME (K2A-SERIES)
PART OR ASSEMBLY:	VERTICAL CROSS SECTIONS

NO.	DATE	BY	REVISIONS

DATE: 10/23/15
SCALE: N.T.S.
DWG. BY: JK
CHK. BY: LFS
DRAWING NO.: FL-14512.4
SHEET 7 OF 10

R:\Clients\YDP PERMANENT\A - Florida Product Approvals\FL-14512\C - Drawings\Current\FL-14512.4.dwg, 8.1

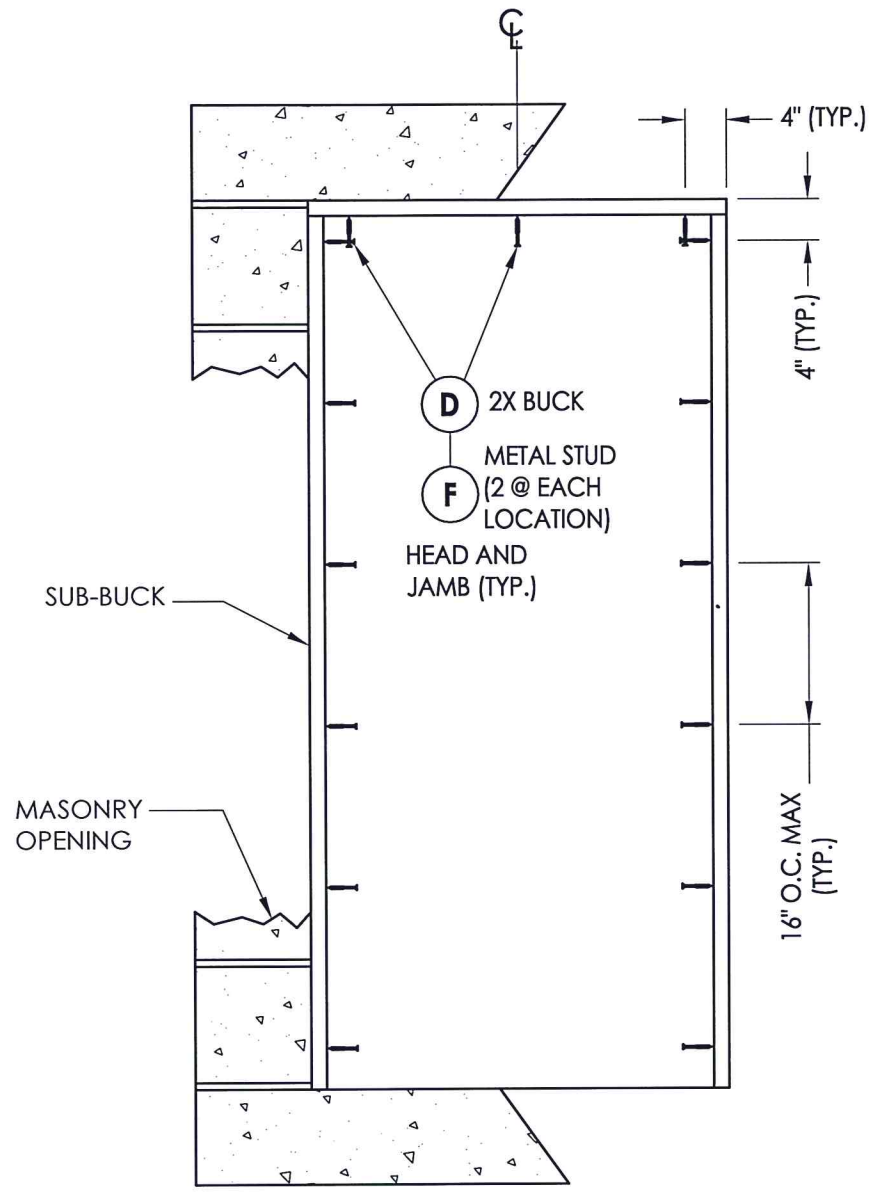

BUCK ANCHORING
7' Door

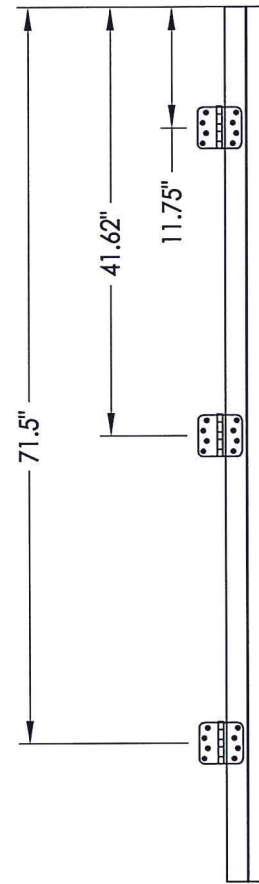

HINGE JAMB

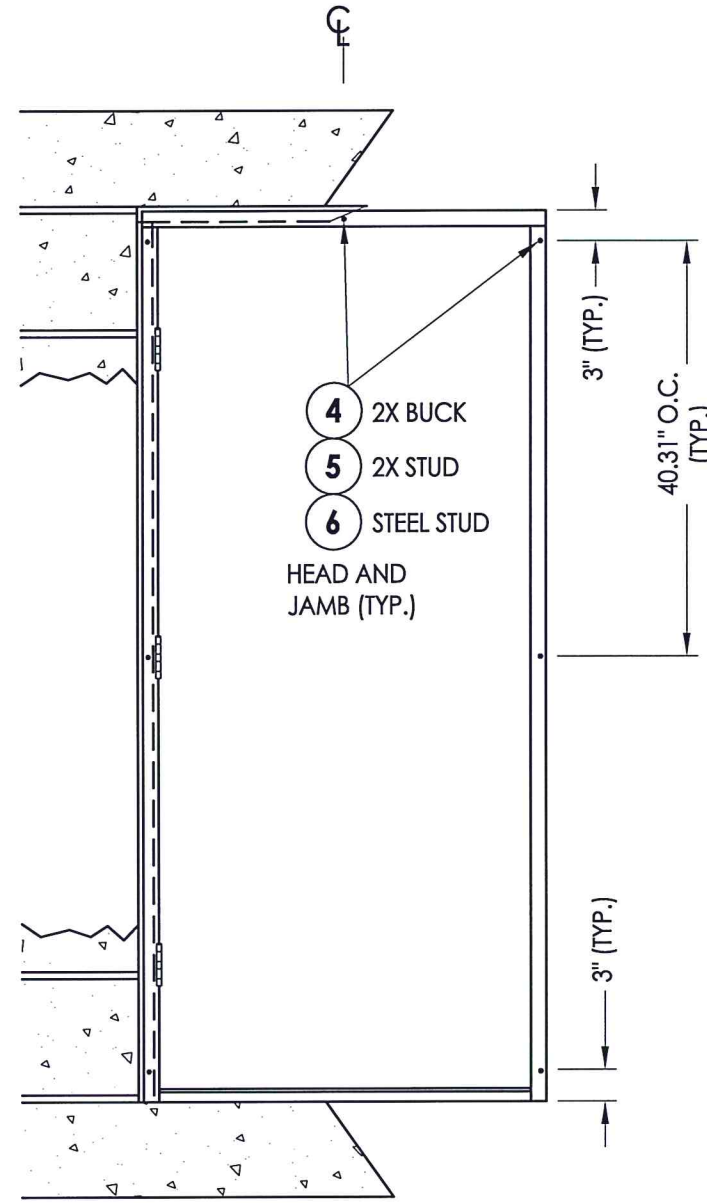

BUCK ANCHORING
7' Door

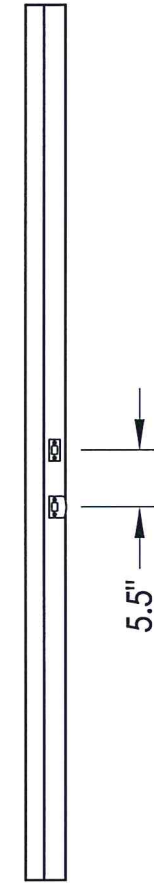

STRIKE JAMB

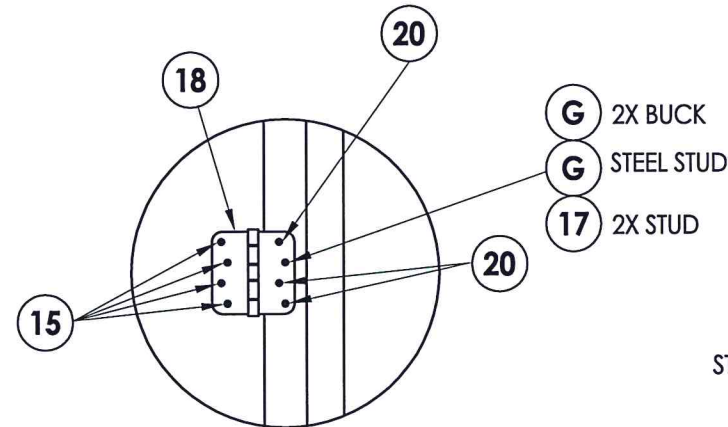

HINGE DETAIL

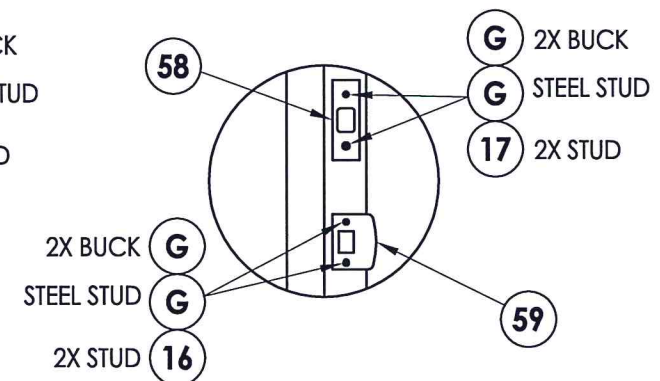

STRIKE PLATE DETAIL

CONCRETE ANCHOR NOTES:

- Concrete anchor locations at the corners may be adjusted to maintain the min. edge distance to mortar joints.
- Concrete anchor locations noted as "MAX. ON CENTER" must be adjusted to maintain the min. edge distance to mortar joints, additional concrete anchors may be required to ensure the "MAX. ON CENTER" dimension are not exceeded.
- Concrete anchor table:

ANCHOR TYPE	ANCHOR SIZE	MIN. EMBEDMENT	MIN. CLEARANCE TO MASONRY EDGE	MIN. CLEARANCE TO ADJACENT ANCHOR
ITW TAPCON®	1/4"	1-1/4"	2"	4"
ELCO ULTRACON®	1/4"	1-1/4"	1"	4"
ITW TAPCON®	3/16"	1-1/4"	3"	1-1/2"

WOOD SCREW INSTALLATION NOTES:

- Maintain a minimum 5/8" edge distance, 1" end distance, & 1" o.c. spacing of wood screws to prevent the splitting of wood.

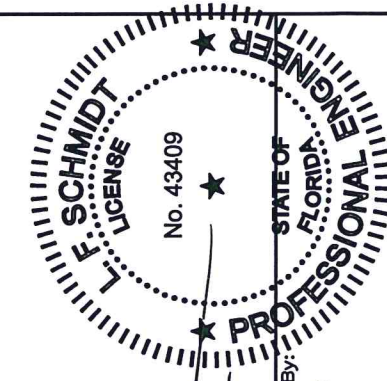

Documents Prepared By:
Lyndon F. Schmidt
P.E. No. 43409

R.W. BUILDING CONSULTANTS, INC.
P.O. Box 230, Vairico, FL 33595
Phone No.: 813.659.9197
FBPE C.A. No. 9813

PRODUCT: IDP STEEL FRAME (K2A-SERIES)
PART OR ASSEMBLY: FRAME AND BUCK ANCHORING (7'-0" DOOR)

NO.	DATE	BY	REVISIONS

DATE: 10/23/15
SCALE: N.T.S.
DWG. BY: JK
CHK. BY: LFS
DRAWING NO.: FL-14512.4
SHEET 8 OF 10

R:\Clients\IDP PERMANENT\A - Florida Product Approvals\FL-14512\C - Drawings\Current\FL-14512.4.dwg, 9.1

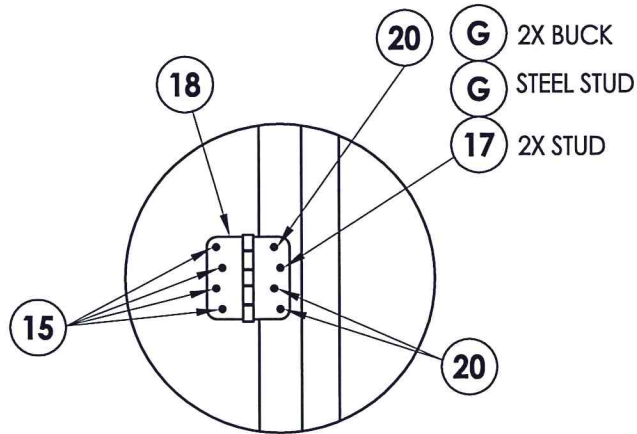

HINGE DETAIL

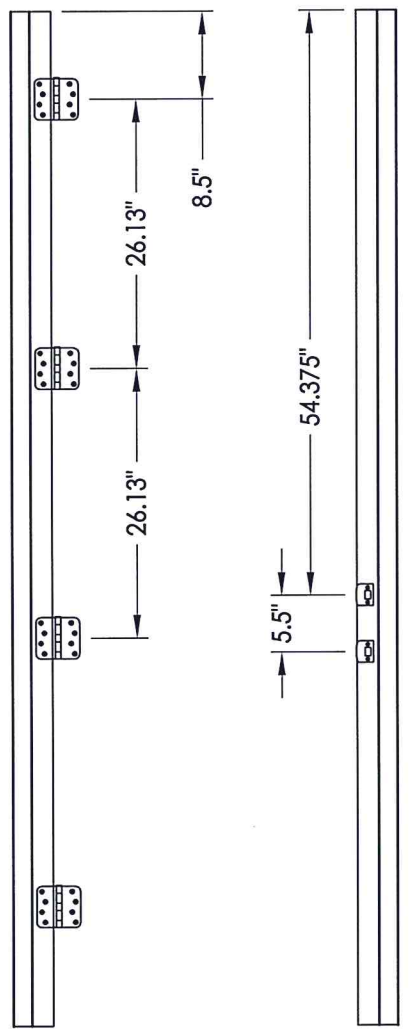

HINGE JAMB

STRIKE JAMB

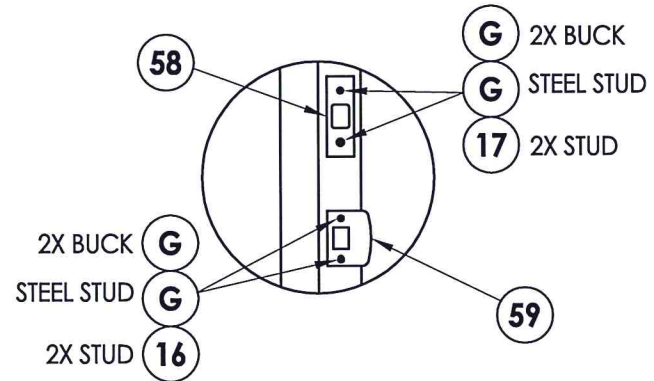

STRIKE PLATE DETAIL

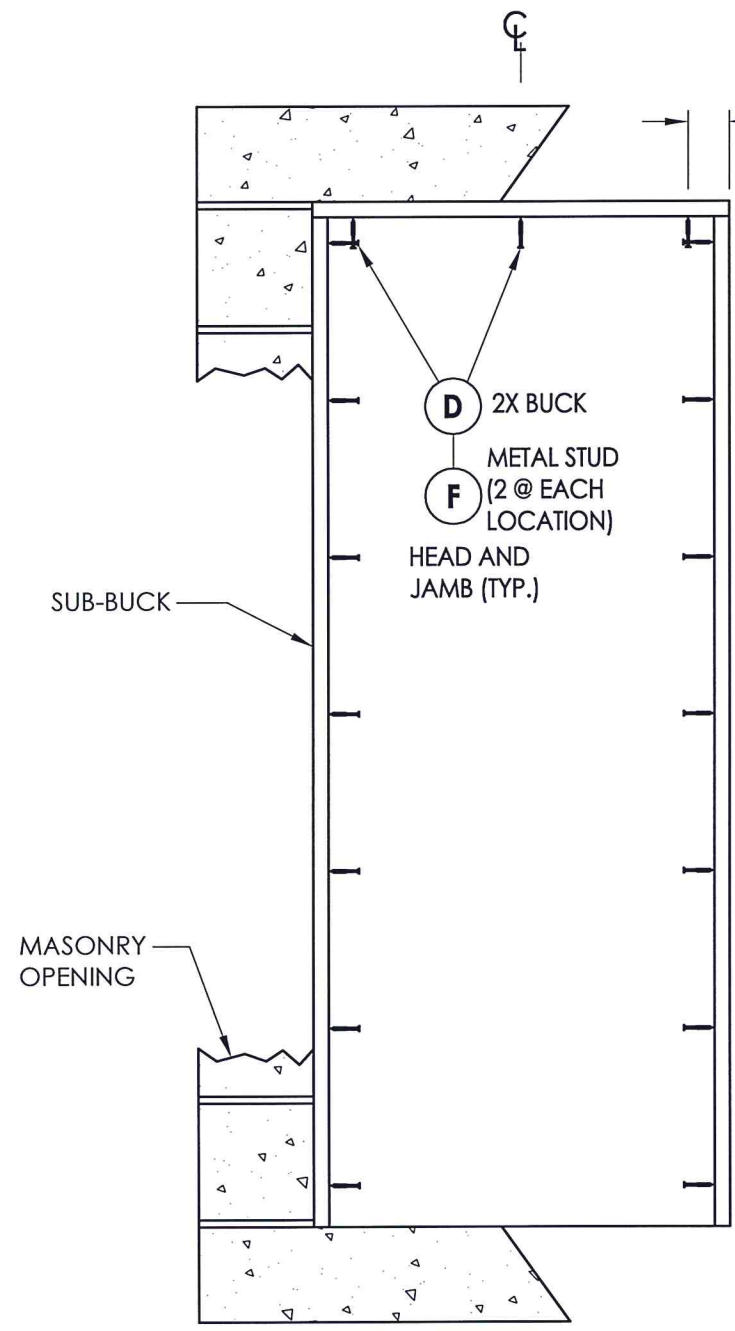

BUCK ANCHORING
8' Door

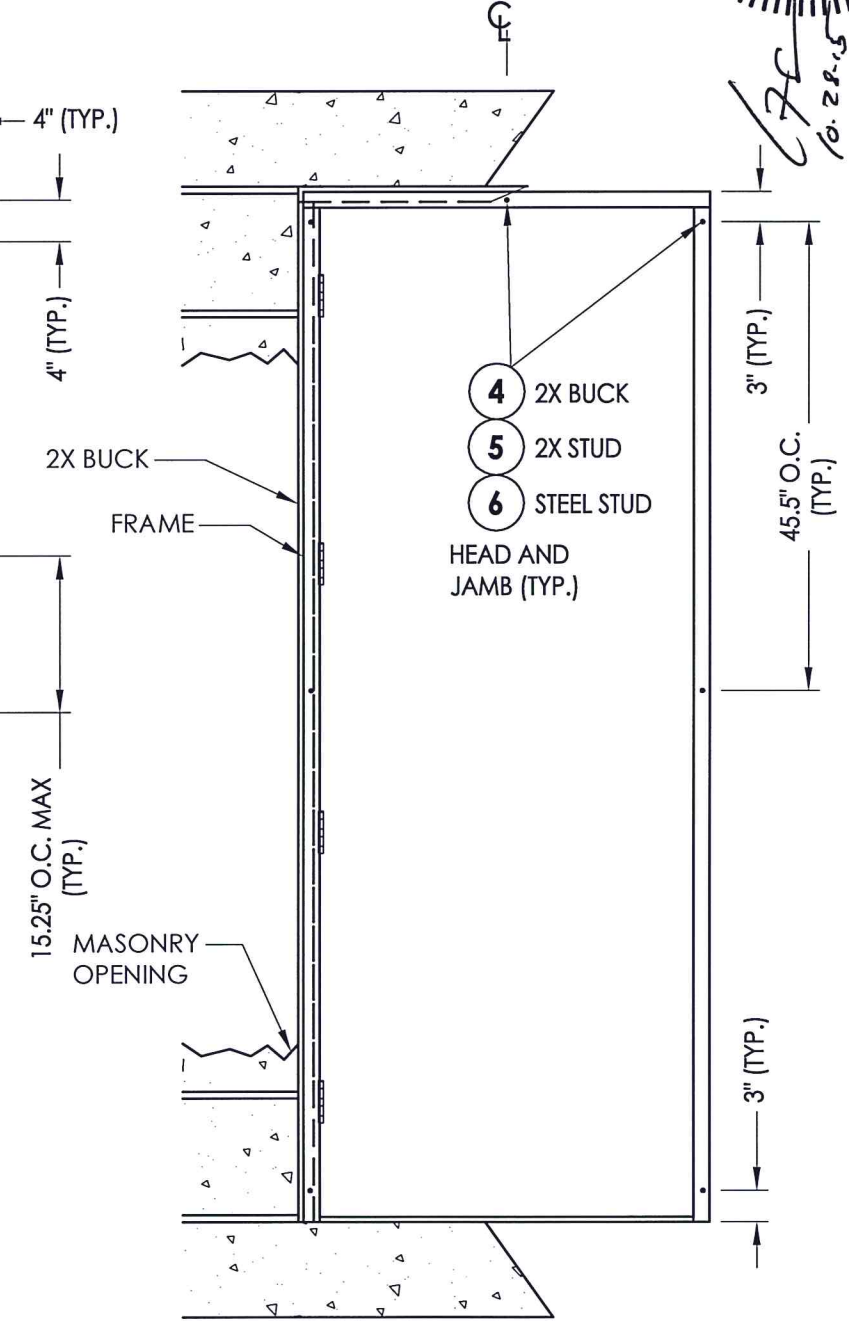

FRAME ANCHORING
8' Door

CONCRETE ANCHOR NOTES:

1. Concrete anchor locations at the corners may be adjusted to maintain the min. edge distance to mortar joints.
2. Concrete anchor locations noted as "MAX. ON CENTER" must be adjusted to maintain the min. edge distance to mortar joints, additional concrete anchors may be required to ensure the "MAX. ON CENTER" dimension are not exceeded.
3. Concrete anchor table:

ANCHOR TYPE	ANCHOR SIZE	MIN. EMBEDMENT	MIN. CLEARANCE TO MASONRY EDGE	MIN. CLEARANCE TO ADJACENT ANCHOR
ITW TAPCON®	1/4"	1-1/4"	2"	4"
ELCO ULTRACON®	1/4"	1-1/4"	1"	4"
ITW TAPCON®	3/16"	1-1/4"	3"	1-1/2"

WOOD SCREW INSTALLATION NOTES:

1. Maintain a minimum 5/8" edge distance, 1" end distance, & 1" o.c. spacing of wood screws to prevent the splitting of wood.

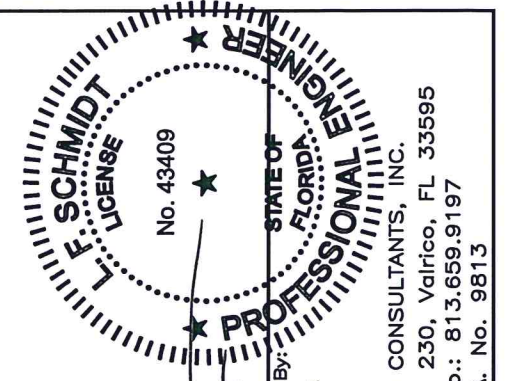

Documents Prepared By:
Lyndon F. Schmidt
P.E. No. 43409

RW

BUILDING CONSULTANTS, INC.
P.O. Box 230, Valrico, FL 33595
Phone No.: 813.659.9197
FBPE C.A. No. 9813

PRODUCT: IDP STEEL FRAME (K2A-SERIES)
PART OR ASSEMBLY: FRAME AND BUCK ANCHORING (8'-0" DOOR)

NO.	DATE	BY	REVISIONS

DATE: 10/23/15
SCALE: N.T.S.
DWG. BY: JK
CHK. BY: LFS
DRAWING NO.: FL-14512.4
SHEET 9 OF 10

BILL OF MATERIALS

ITEM #	DESCRIPTION	MATERIAL
A	2X STUD FRAMING (SG >= 0.55)	WOOD
B	2X BUCK (SG >= 0.55)	WOOD
C	METAL STUD (SSMA STUD 550S162-54, Fy = 33 ksi, Fu = 45 ksi)	STEEL
D	1/4" X 2-3/4" ELCO OR ITW PFH CONCRETE SCREW	STEEL
E	MASONRY - 3,000 PSI MIN. CONCRETE CONFORMING TO ACI 301 OR BLOCK CONFORMING TO ASTM C90 OR ASTM A653 STEEL	HOLLOW CONCRETE
F	3/16" X 1-3/4" HWH ITW CONCRETE SCREW	STEEL
G	3/16" X 3-1/4" ELCO OR ITW PFH CONCRETE SCREW	STEEL
H	1/4" X 2-1/4" ELCO OR ITW PFH CONCRETE SCREW	STEEL
4	#10 X 1-1/2" PPH SMS (1-1/4" MIN. EMBEDMENT)	STEEL
5	#10 X 2" PPH SMS (1-1/4" MIN. EMBEDMENT)	STEEL
6	#10 X 3/4" HWH SELF-DRILLING TEK SCREW (3 THREADS MUST PROTRUDE THRU STEEL)	STEEL
7	COMPRESSION WEATHERSTRIPPING QLON QDS 650 BY SCHLEGEL	-
8	SWEEP	PVC
15	10-24 X 5/8" PFH MS	STEEL
16	#8 X 2-1/2" PFH WS	STEEL
17	#10 X 2-1/2" PFH WS	STEEL
18	4.0" X 4.0" HINGE	STEEL
19	8-32 X 3/8" PFH MS	STEEL
20	10-24 X 1/2" PFH MS	STEEL
22	IDP (K2A-SERIES) EXTERIOR FRAME (18 GA. - A60 GALVANNEALED STEEL)	STEEL
23	IDP (K2A-SERIES) INTERIOR FRAME (22 GA. - A60 GALVANNEALED STEEL)	STEEL
28	HINGE LATCH AND DEADBOLT REINFORCEMENT	STEEL
29	HINGE REINFORCEMENT	STEEL
30	OUTSWING THRESHOLD	ALUM/WOOD
31	INSWING THRESHOLD	ALUM/COMP
32	OUTSWING THRESHOLD	ALUM/COMP
33	ADA THRESHOLD	ALUM
40	8' DOOR - SEE DOOR PANEL DETAILS	-
50	7' DOOR - SEE DOOR PANEL DETAILS	-
58	STRIKE PLATE - DEADBOLT	STEEL
59	" T " STRIKE PLATE - LATCH	STEEL

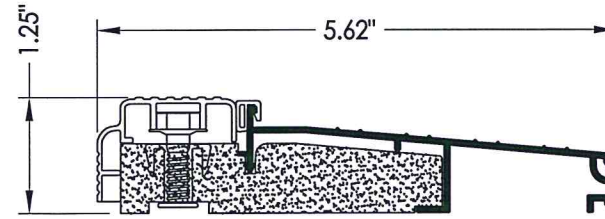

31 INSWING THRESHOLD
AFCO

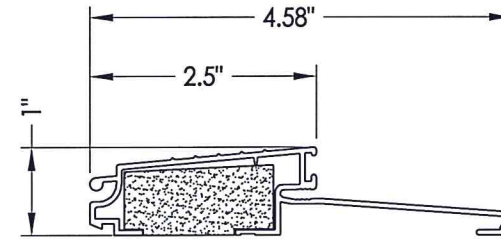

32 OUTSWING THRESHOLD
AFCO

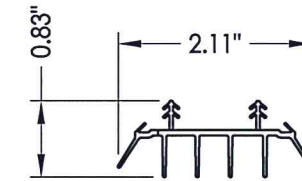

8 SWEEP

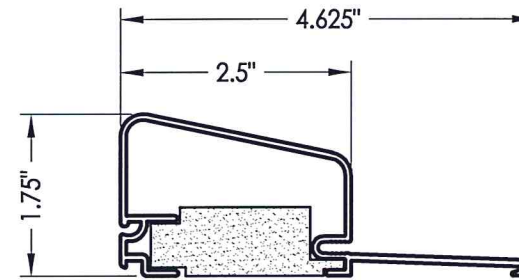

30 OUTSWING THRESHOLD
AFCO

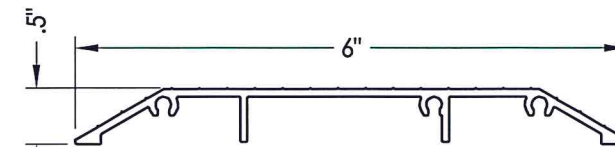

33 ADA THRESHOLD
AFCO A-202

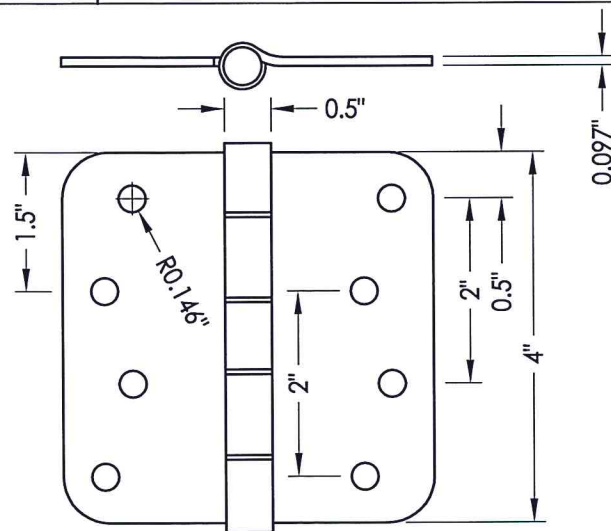

18 HINGE

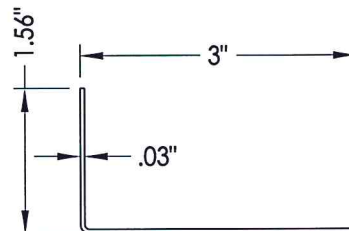

23 INTERIOR FRAME

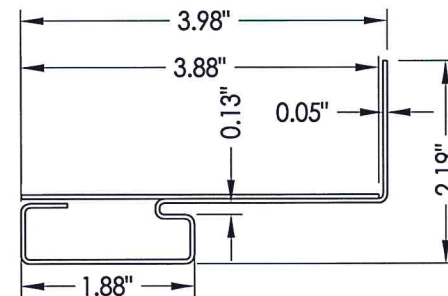

22 EXTERIOR FRAME

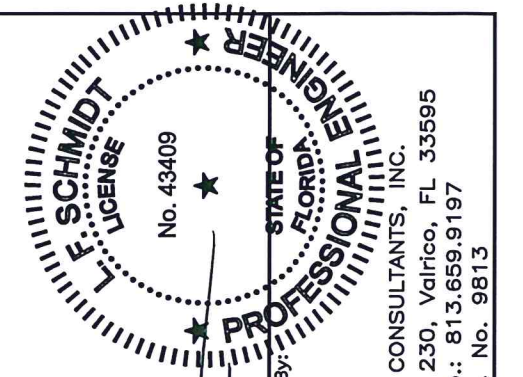

Documents Prepared By:
Lyndon F. Schmidt
P.E. No. 43409

LFS
10.26.15

R.W.
BUILDING CONSULTANTS, INC.
P.O. Box 230, Vairico, FL 33595
Phone No.: 813.659.9197
FBPE C.A. No. 9813

PRODUCT:	IDP (K2A-SERIES)
PART OR ASSEMBLY:	STEEL FRAME (K2A-SERIES)
BILL OF MATERIALS AND COMPONENTS	
NO.	DATE
BY	REVISIONS
DATE: 10/23/15	
SCALE: N.T.S.	
DWG. BY: JK	
CHK. BY: LFS	
DRAWING NO.: FL-14512.4	
SHEET 10 OF 10	